



# MEDICAL GRADE TUBING



ACI offers a 1/4" diameter, flexible push-on medical grade tubing kit to be used in conjunction with the MLP2, DLP, DBL and PUP Series pressure transmitters, switches and all pickup ports. The standard lengths of 10 Feet, 20 Feet, and 100 Feet are available and can be used with any 3/16" diameter barbed or non-barbed style fittings.

**Applications:** Indoor/Outdoor Weatherproof Pickup Port for Building Static Pressure Applications

**The Pick Up Port Series is covered by ACI's Five (5) Year Limited Warranty. The warranty can be found in the front of ACI's Sensors & Transmitters catalog, as well as on ACI's website, [www.workaci.com](http://www.workaci.com).**

## PRODUCT SPECIFICATIONS

<b>Fitting Size Accepted:</b>	3/16" (4.76 mm)
<b>Maximum Operating Pressure:</b>	39 psi maximum @ 70°F (21.1°C)
<b>Operating Temperature Range:</b>	35° to 122°F (2° to 50°C)
<b>Brittleness Temperature:</b>	-47.2°F (-44°C)
<b>Storage Temperature Range:</b>	0 to 122°F (32° to 50°C)
<b>Enclosure Material   Flammability Rating:</b>	Medical Grade Flexible PVC   Self Extinguishing
<b>Tubing Color:</b>	Clear
<b>Product Dimensions (ID x OD x L)   Weight:</b>	<p><b>A/10' Tube:</b> 0.17" (4.32 mm) x 1/4" (6.35 mm) x 10' (3.05 m) / 0.30 lbs (0.136 kg)</p> <p><b>A/20' Tube:</b> 0.17" (4.32 mm) x 1/4" (6.35 mm) x 20' (6.10 m) / 0.50 lbs (0.226 kg)</p> <p><b>A/100' Tube:</b> 0.17" (4.32 mm) x 1/4" (6.35 mm) x 100' (30.5 m) / 2.3 lbs (1.05 kg)</p>
<b>Agency Approvals:</b>	Complies with relevant section Title 21 of the Code of Fed. Reg., RoHS2, WEEE, Reach





**DIMENSIONAL DRAWING**

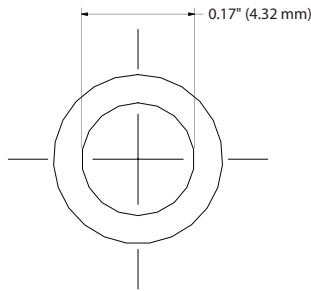

Front View

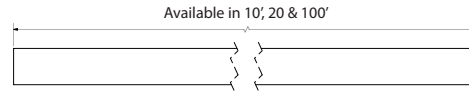

Right View

**STANDARD ORDERING**

Model # Example: **A/10'TUBE** -OR- **126606**

Model #	Item #	Description	Color
<b>A/10' TUBE</b>	126606	10' Medical Tubing Kit, 0.17" ID x 1/4" OD	Clear
<b>A/20' TUBE</b>	132226	20' Medical Tubing Kit, 0.17" ID x 1/4" OD	Clear
<b>A/100' TUBE</b>	136018	100' Medical Tubing Kit, 0.17" ID x 1/4" OD	Clear

